

## ST-WIFI-G2 User Manual—V1.1

RENAC Power Technology Co., LTD.,

### 1 Electrical connection

Plug the ST-WIFI-G2 module into the COM port of the inverter.

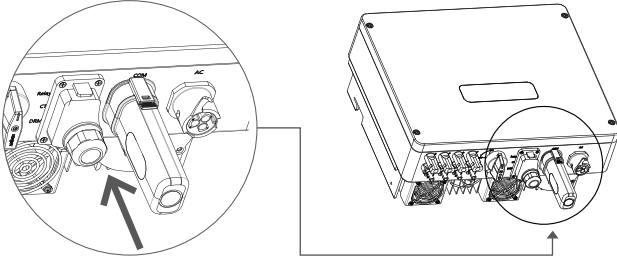

### 2 Turn on inverter and check ST-WIFI-G2 state

After installing the ST-WIFI-G2 module, turn on the inverter, below is the LED state of the module.

LED State	Indication
LED off	The LED default is off before pressing the button to configuration mode.
LED green and blinking	The module is searching network and under configuration.
LED stay on green	The WIFI configuration is successful.

### 3 Registration and adding device

#### 1. Download & Install Mobile APP

1.1 Scan the QR code below to download Renac SEC, also you can search Renac SEC in iOS or Google Play Store, download and install it.



#### 1.2 Install <Renac SEC> & Enable Permissions

After installed APP on mobile phone, please set all the permissions of the APP to be enabled in the "Settings"->"Apps"->"Permissions".

### 2. Registration

2.1 Open the APP, fill out requirement information to create a new account, then click "Submit".

Email / Username  
 Enter your Password  
 Forgot Password  
 LOG IN  
 Register

Username  
 Enter your Username  
 Email  
 Enter your Email address  
 Password  
 Enter your Password

Confirm Password  
 Enter confirm password  
 SUBMIT  
 LOG IN

2.2 After entering the newly created account, the system will automatically enter into the "Add station" page.

Remark:

If you want to add more stations to an existing account, after entering into the account, click "EQ" on the home interface to enter to the station list, and click "+" to add a station.

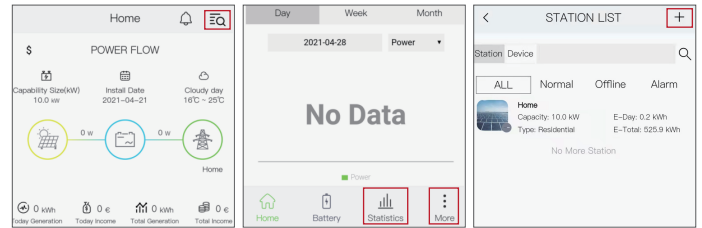

2.3 If the pop-up message is as shown below, please turn on mobile phone's GPS and click "OK". Thus the system will automatically locate the longitude and latitude of the power station.

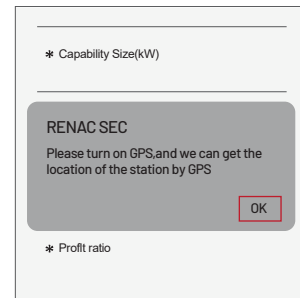

2.4 On the "Add station" page, fill out the required information; click "Submit" to add a new power station.

Note:

For 'Installer' option, enter the installer account name will add this power station to this installer account. Keep it empty if it is not sure. The station type must be chosen correctly.

ADD STATION  
 Plant name  
 Installer's name (If you don't know, please keep it empty)  
 Capacity Size(kW)  
 Install Date  
 Station type  
 Residential  
 Profit ratio  
 Longitude  
 Latitude  
 Upload photos

Latitude  
 31.35649242  
 Upload photos  
 SUBMIT

2.5 After adding the power station, back to home page, and the newly added power station will be shown in the station list. Please see the figure in chapter 2.2.

2.6 On the home page, click "Statistics" to enter into the equipment list. Please see the figure in chapter 2.2.

2.7 Click "+" and scan the QR code (inverter serial number) on the device label to add a device.

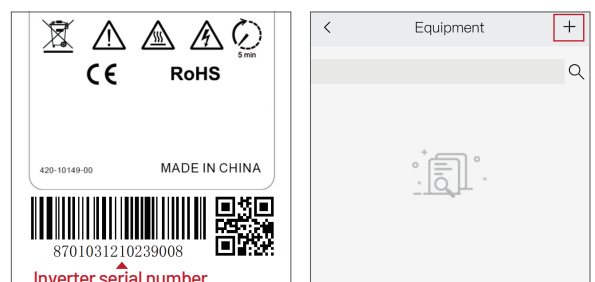

2.8 Confirm the device information and click "Submit".



### 3. Bluetooth Configuration (WIFI Setting)

3.1 Press the button for 1-2 seconds ( don't press more than 5 seconds ) , start wifi configuration when the indicator LED of the module is green and blinking. The button as shown in the figure below:

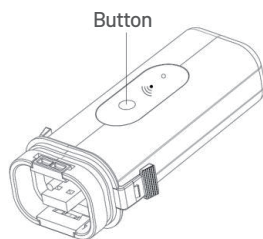

3.2 Connect mobile phone to the WiFi of home router which the ST-WIFI-G2 module will be connected.

- The router name should consist with English letters and numbers, it does not support special symbols.
- For safety reason, please use an encrypted wireless network.
- It does not support a public network that uses a secondary authentication.
- It does not support bridge network.

3.3 Open the Renac SEC, on the home page, click "More". Please see the figure in chapter 2.2.

3.4 Click "WiFi setting".

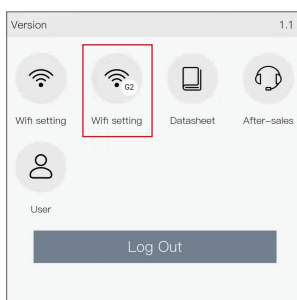

3.5 If the pop up a message says as below figure shown, please turn on your phone's Bluetooth and click "OK".

Remark:

- The mobile phone must be with Bluetooth function.
- The Bluetooth must be version 4.0 or higher.
- WIFI setting through Bluetooth it only supports 2.4GHz wireless signal, but doesn't support 5.0GHz.

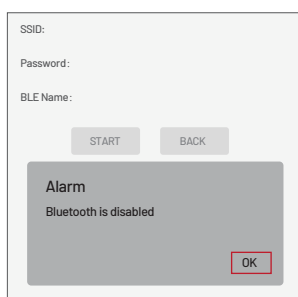

3.6 The router's SSID will be automatically displayed on "Wifi Setting" interface (if not, please manually type in router's SSID or follow 1.2 to confirm the permission of APP). Enter router's password and click "START". Please mind that the BLE Name is Renac as default and can't be changed.

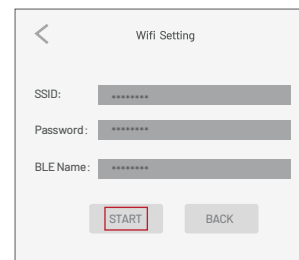

3.7 The system starts to search the device, it takes about a few seconds, when the pop up a message says "Linked module" and the LED of WIFI module stops blinking and finally stay on green, the configuration is finished and successful. Click "OK".

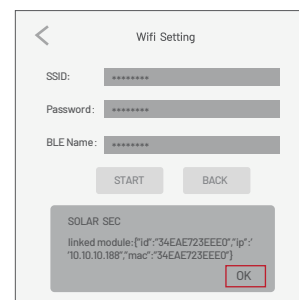

3.8 After successful configuration, it will move to "Home" page, select the inverter in equipment list to check the inverter update information, and the inverter status will be green. This means that the ST-WIFI-G2 monitoring configuration has been done and successful.

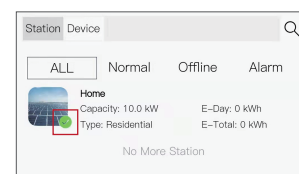

### 4. Browser Configuration(AP mode)

4.1 Long press the button for more than 5 seconds, which is equivalent to factory reset, there will be no indicator light on the WIFI module.

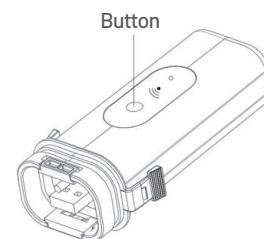

4.2 Open the Renac SEC, on the home page, click "More". Please see the figure in chapter 2.2.

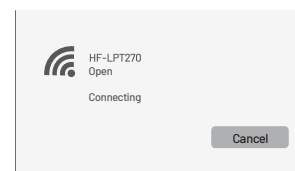

4.3 Open a browser and enter 10.10.100.254, then fill in username and password, both of which are admin as default.

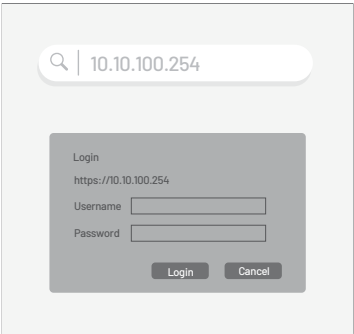

4.4 Click STA setting, then click Scan to choose the Network Name (SSID) and enter password. After that click Save to save. It can also be entered manually.

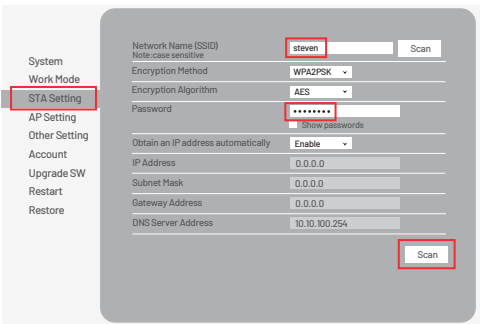
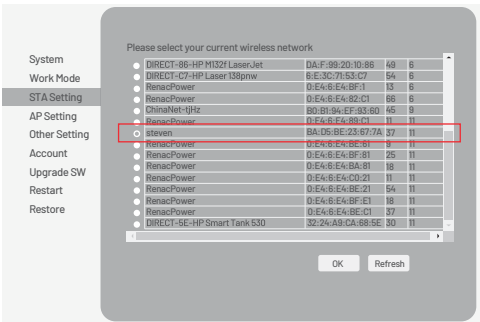
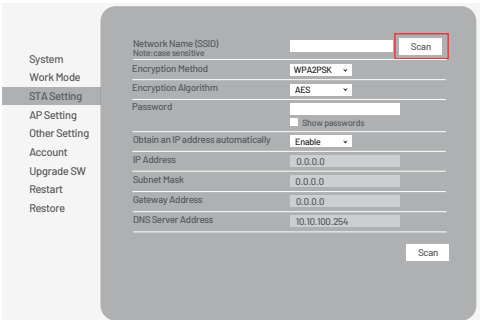

As shown in the picture below, it doesn't recommend to click Restart at first time, but click Back.

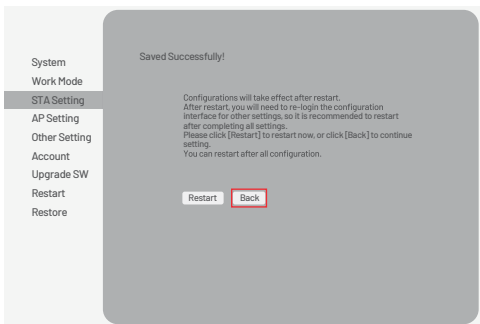

4.5 Go back to the main page, click Work Mode and select "STA mode", click Save to save.



4.6 Click Restart. All settings will be saved.

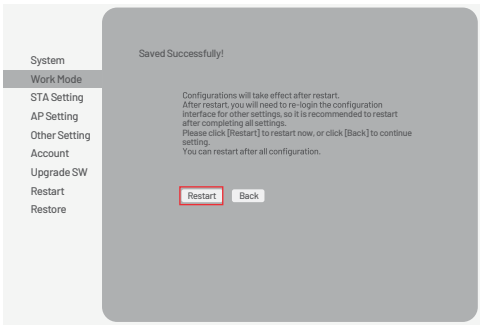

4.7 If the green light of the WIFI module is always on, it indicates that the connection with the router is successful. Close the browser and, the configuration is completed.

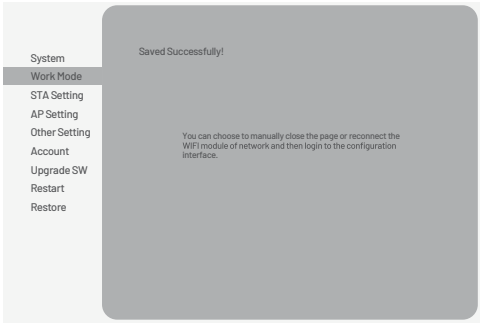

**Note:** WIFI module needs to be reconfigured if the network condition changes.

Appendix A: Troubleshooting

LED State	Indicate	Troubleshooting
LED is off.	ST-WIFI-L can not find inverter via COM port.	1. Try to reconnect ST-WIFI-L to the inverter COM port.
After configuration, LED is green and blinking.	The configuration is unsuccessful.	1. Reconfigure the module.
After configuration, LED stay on green, but no data shown in monitoring system.	The configuration is successful. Data is not transmitted.	1. Check whether the router is connected to the internet. 2. Restart the router. If following above steps no help, please contact technical support.