

Powercase Quick Installation Guide

1. Introduction

Powercase is a battery box which is compatible with RENAC hybrid inverter (ESC Series). Configured with powercase, customers just need to connect several wires between inverter and Powercase / battery. And one hybrid inverter can be connected 2 powercases total 14.32kWh.

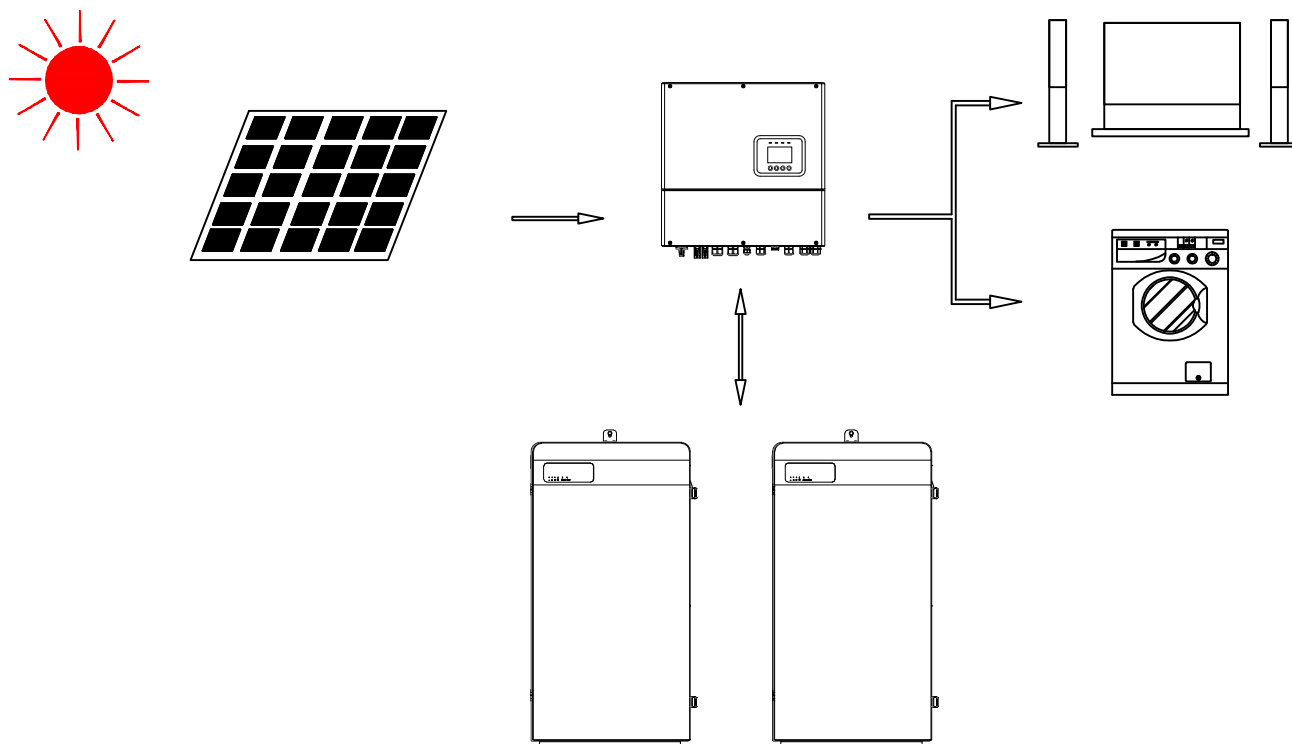

2. Packing List

Check that if there is any distortion or impaired during transportation.

Main powercase accessories:

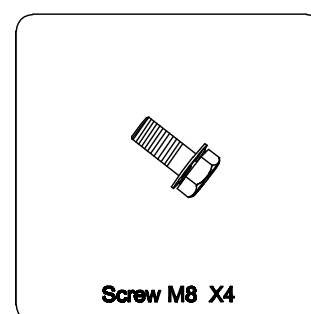
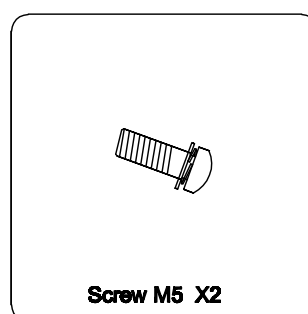
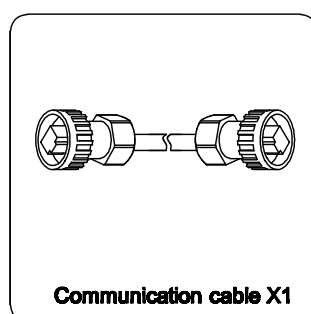
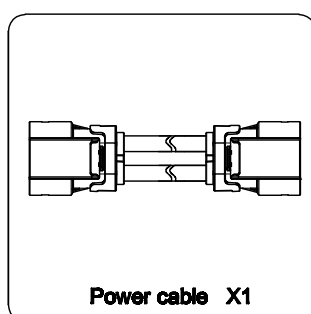
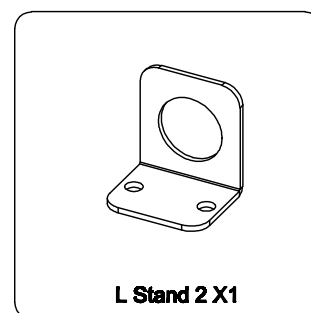
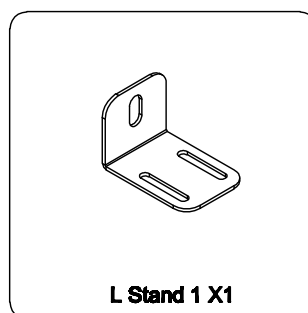
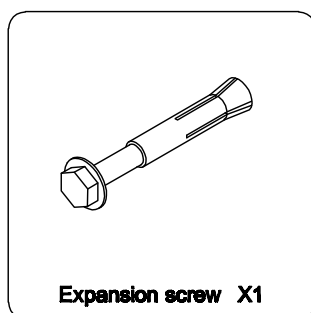
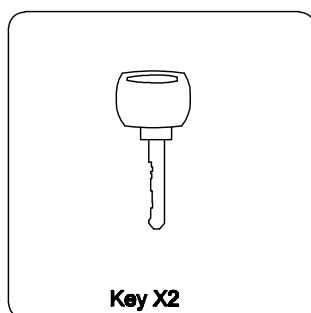

Slave powercase accessories:

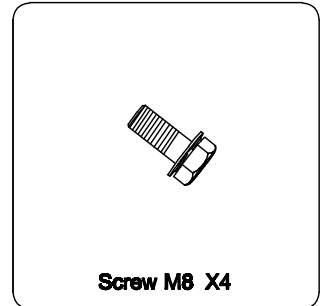
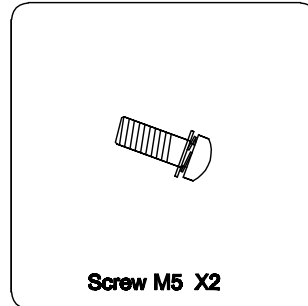
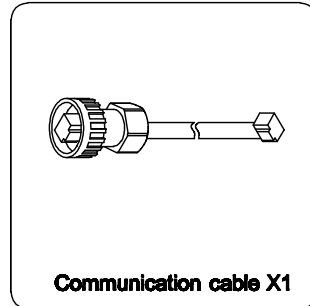
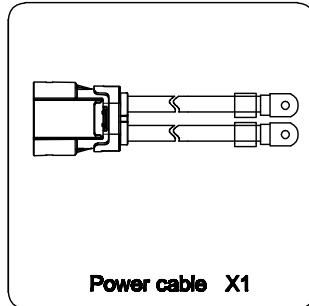
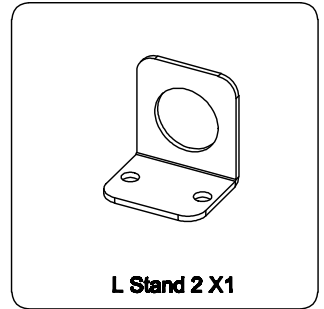
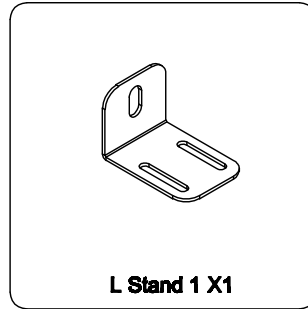
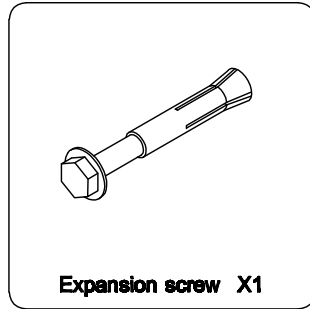
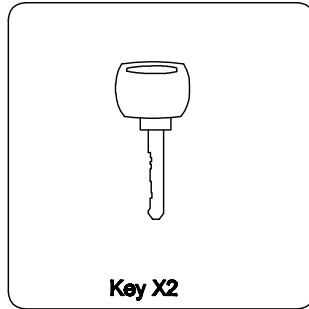

3. Installation (1 Powercase 7.16kWh)

3.1 Mounting

Fix the cabinet on the wall.

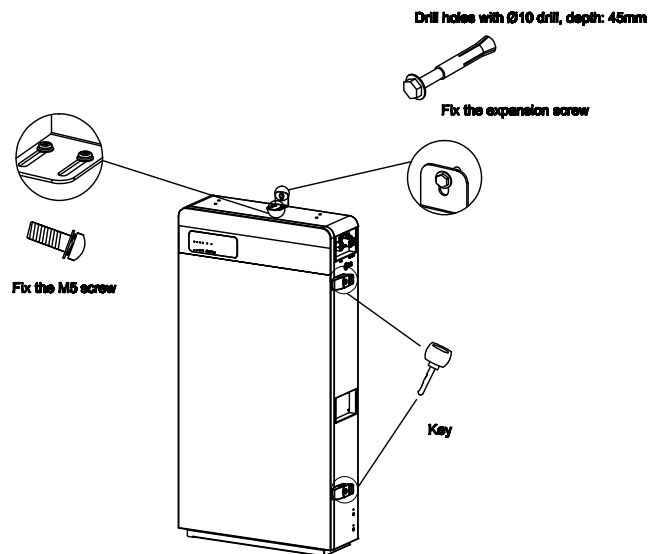

If you install two L Stand 2 for powercase, it will help you to fix the cabinet and make the installation more convenient.

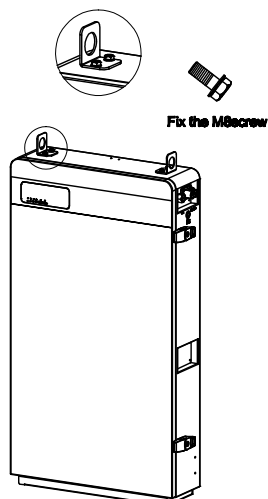

3.2 Open the box

Unlock and open the cabinet as follow.

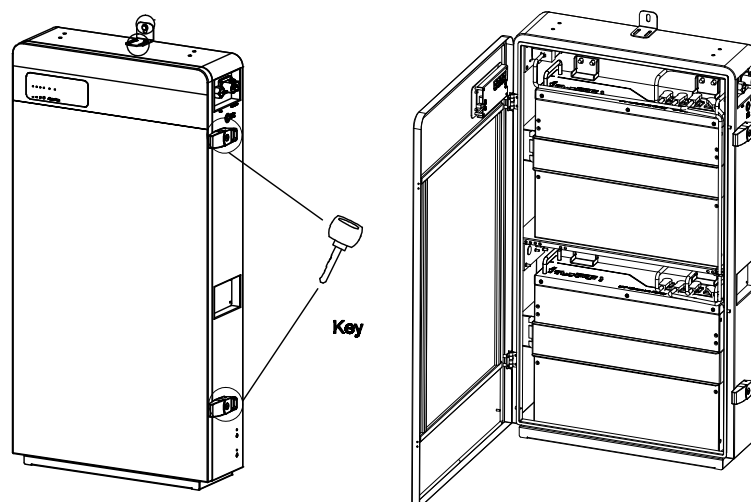

3.3. Set battery Address

Set the ADD switch of the main battery to 0001, set the slave battery to 0002.

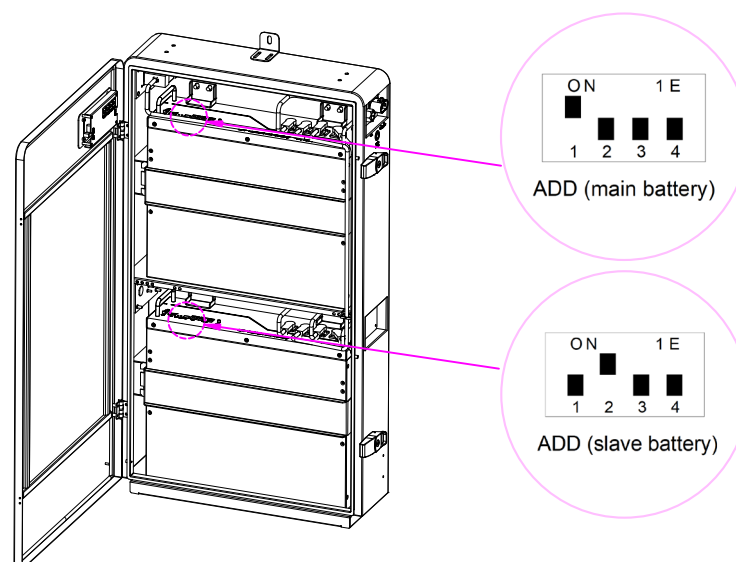

3.4 Wire connection

3.4.1 Inner Wire connection

Plug the battery cables as below figure shown, the color of positive cable is red, the negative cable is black.

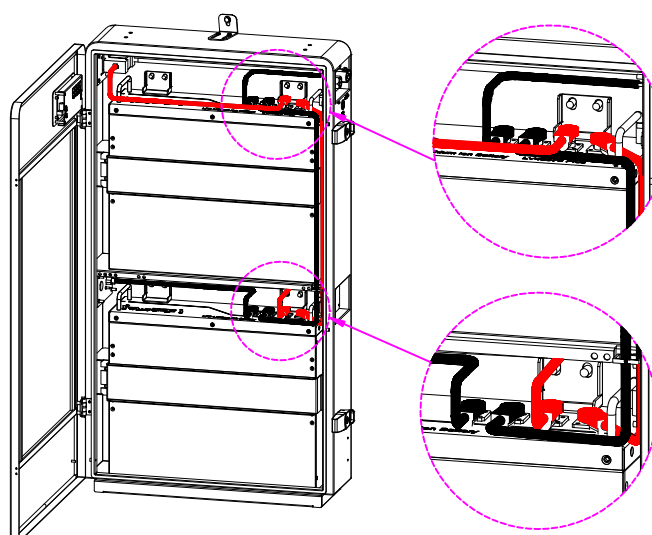

3.4.2 Outer Wire connection

Step1. Plug the power cable (the length is 80cm) into the battery port of power case.

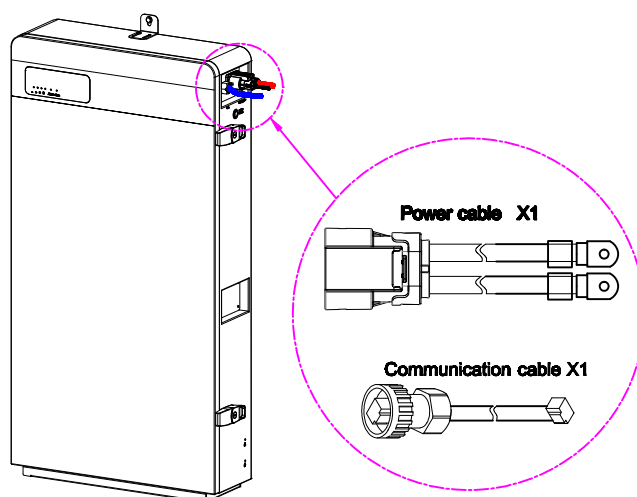

Step2. Install the other side of the cable to the battery port of inverter (The color of positive cable is red, the negative cable is black) and install the battery communication cable (the blue cable is the communication cable).

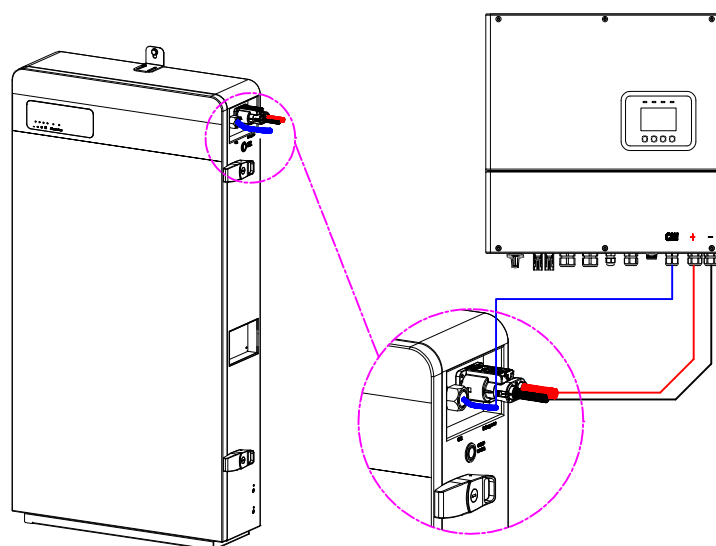

Step3. Install the outer ground cable (ground cable size: 12AWG).

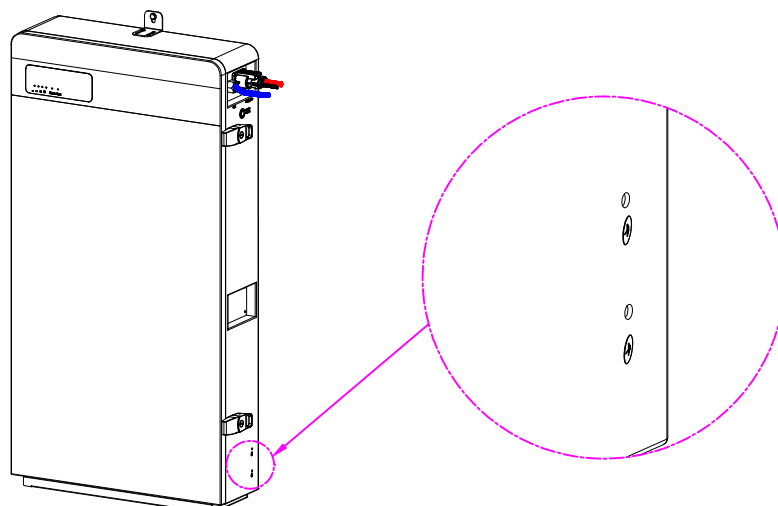

3.5 Operation of power case

Turn on the breaker and switch on the power button.

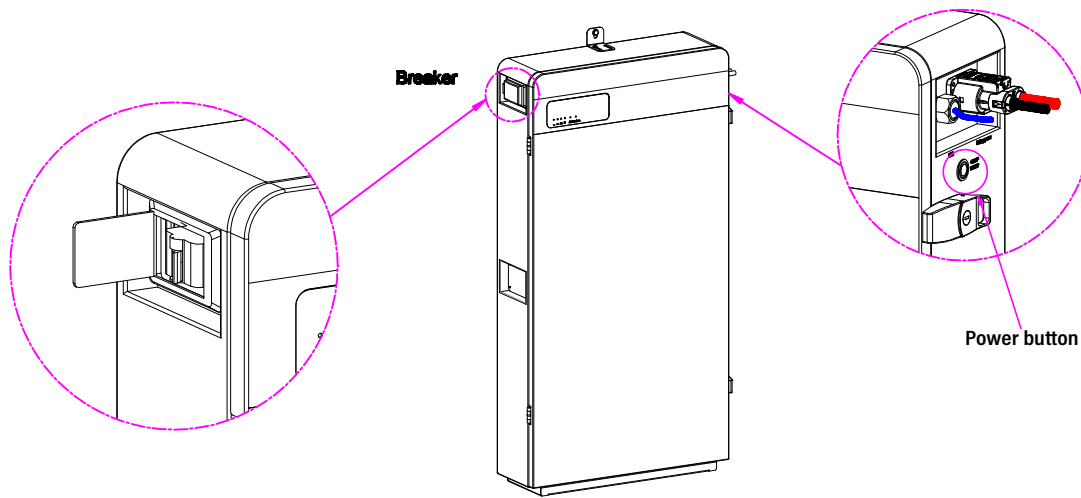

4. Installation (2 Powercases 14.32kWh)

One RENAC hybrid inverter can be connected 2 powercases in parallel for a total of 14.32 kWh.

4.1 Connect the inner wires for slave powercase as below.

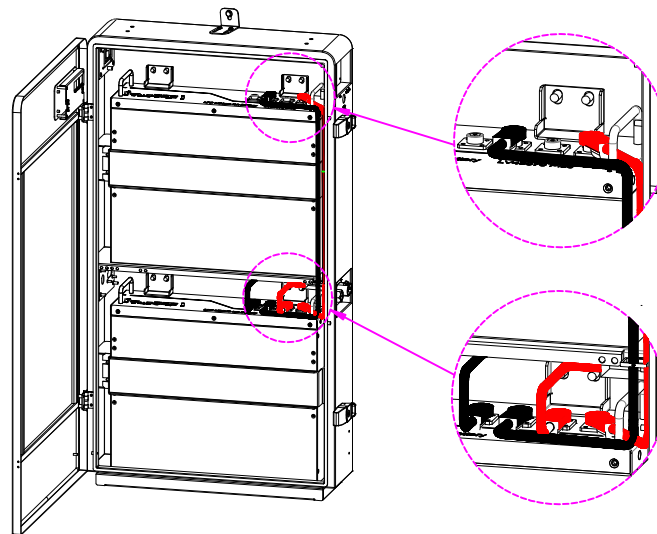

4.2 Connect the slave powercase to the main powercase as below figure shown.

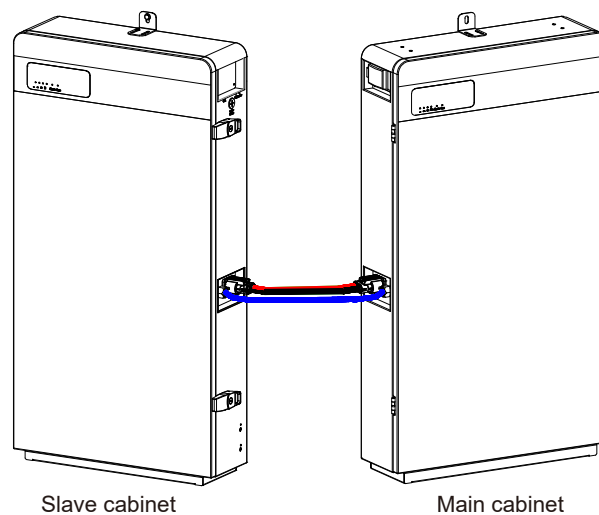

Overview of the installation with 2 powercases:

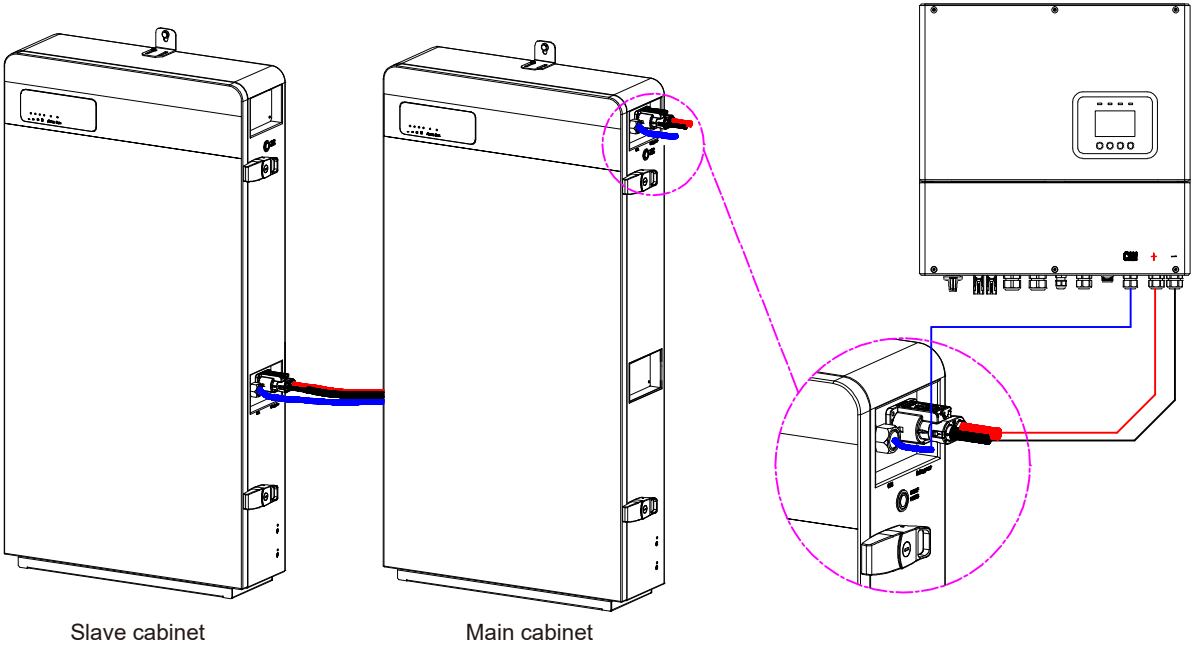

4.3 Set the battery address for two powercases.
Set the ADD switch of the main Powercase to 0001,0002
Set the ADD switch of the slave Powercase to 0003,0004
Below are the details for the settings:

Item		ADD Switch Settings			
		#1	#2	#3	#4
Powercase (main)	Top Battery	ON	OFF	OFF	OFF
	Bottom Battery	OFF	ON	OFF	OFF
Powercase (slave)	Top Battery	OFF	OFF	ON	OFF
	Bottom Battery	OFF	OFF	OFF	ON